

# BRONZE SWING CHECK VALVE

KVS - 101

## SPECIFICATION

- Designed to BS 5154
- Pressure Rating: PN20
- Working Medium: Water, Oil & Steam
- Working Temperature:  $\leq 170^{\circ}\text{C}$
- End Connection: BS21 Taper Threaded (ISO 7) / BS EN10226-2

## MATERIALS

DESCRIPTION	MATERIAL
Body	Bronze CC491K
Cap	Bronze CC491K
Disc	Bronze CC491K
Hinge	Brass CW617N
Hinge Pin	Stainless Steel 2Cr13
Hinge Nut	Brass CW614N

## DIMENSIONS (mm)

DN		L	H
Inches	mm		
1/2"	15	58	37
3/4"	20	66	43
1"	25	76	49
1 1/4"	32	88	57
1 1/2"	40	96	63
2"	50	112	72

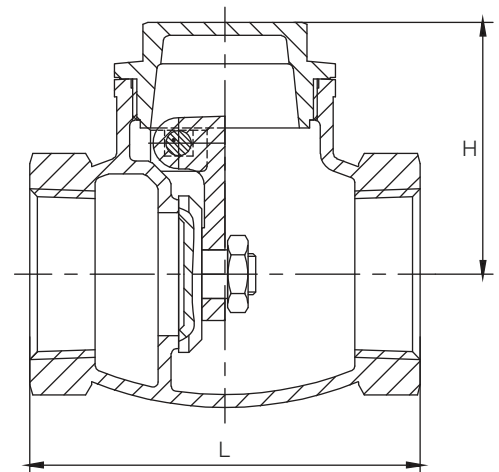

\*All dimensions are nominal. Actual dimensions may vary.